

PRIMARY SCHOOL REDEVELOPMENT (VSBA) MASTER PLAN TO COMPLETION

Churchill North Primary School, Churchill

Project Summary :

- Studio B was engaged from master plan phase through to completion, addressing objectives by provision of thorough site and school entitlement area analysis, spacial relationship assessment, Safety in Design, project risks management and consultation with project team as well as local community.
- Studio B assisted in analysing project priorities, decanting strategy and developing future opportunities.
- Maintenance, upgrade and modernisation works required to existing shared learning, withdrawal / meeting rooms, wet areas, toilet facilities, multi-purpose space, circulation, storage areas, facility / site access and new landscape areas.
- New toilet amenities and external northern deck adjoining shared learning areas.
- New amenities.
- Construction cost: \$2.6M, Completion in September 2023

Design features include:

- Welcoming entry showcasing student works display and community information, with effective passive supervision and clear sight lines through the campus.
- Active indoor and outdoor connection zones with flexible and adaptable learning spaces.
- Connection zones reinvigorate tired teaching zones in the original complex.
- Improved accessibility and integration of buildings with landscaping and new external seating to play areas.

Shared Learning Layouts

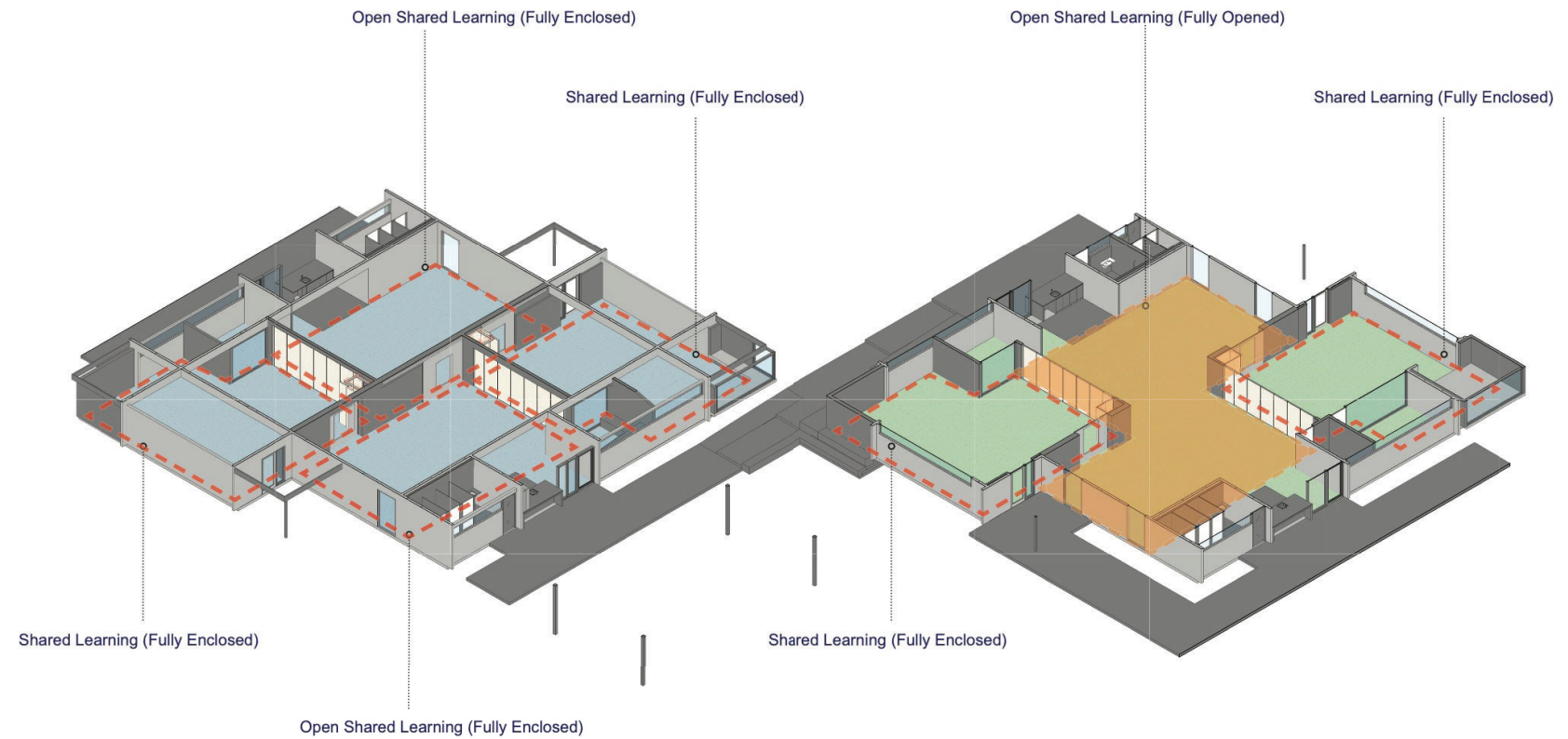

project datasheet

Studio B Architects t. 03 9486 4425 www.studiob.net.au