

MIXED USE DEVELOPMENT & REFURBISHMENT MISSIONAL MASTERPLANNING St John's, Salisbury, Adelaide

Studio B facilitated a Missional Identity and masterplanning exercise for St John's members to determine their priorities. The development investigation identified the potential for an enabling development of retail, offices, medical rooms and other community facilities over five or six floors in the newly designated town centre expansion.

The scheme proposed incorporated a new church entry located at the end of a retail walkway connecting the city centre, making the church a focal point in the marketplace.

Design features include:

- Planning allows town centre to focus on the new transparent entry to the church
- Commercial development intended to financially enable the church facilities development
- Council planning scheme encourages intensification

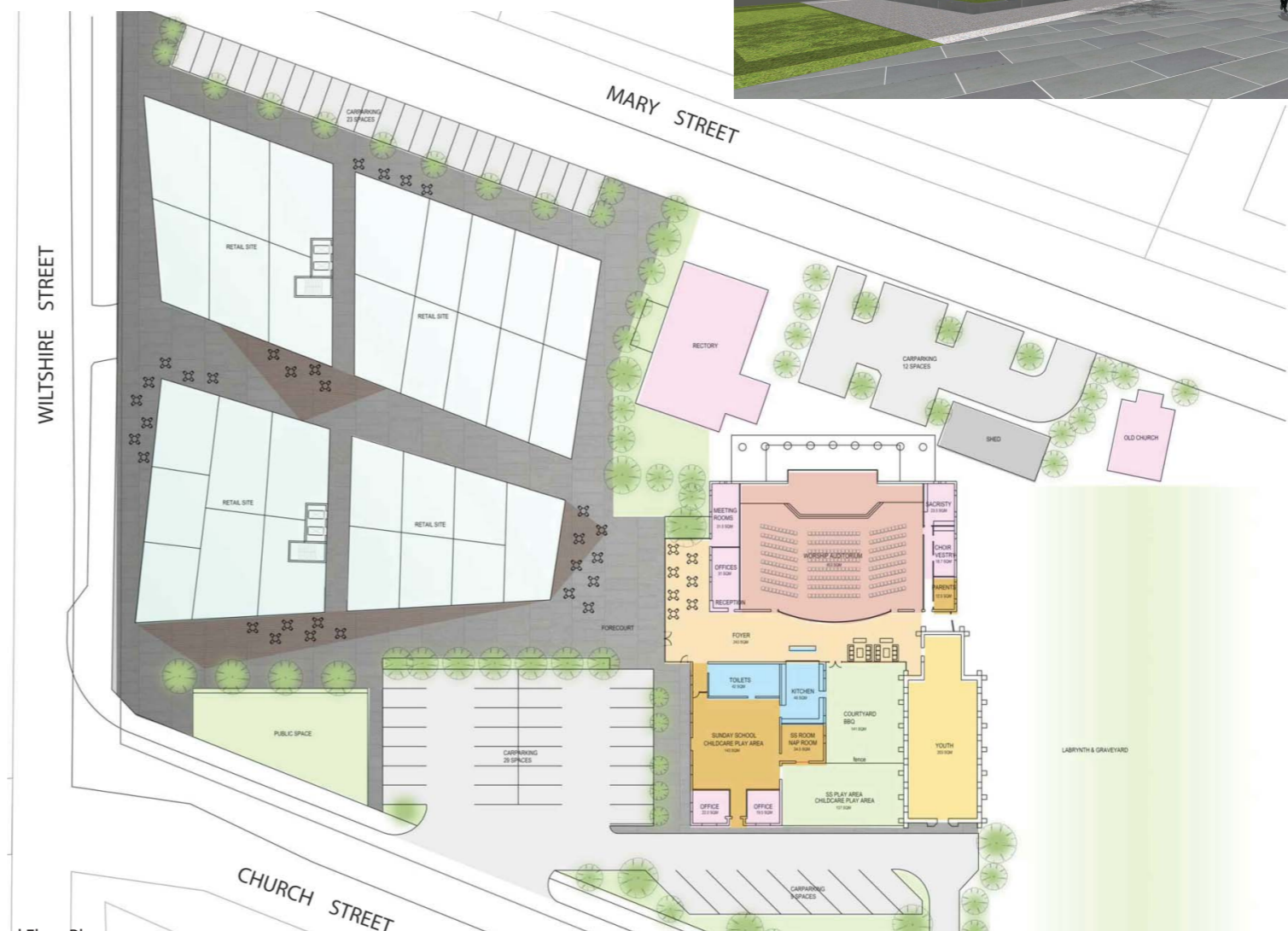

project datasheet

Studio B Architects t. 03 9486 4425 www.studiob.net.au