

# CHURCH EXTENSION & ENABLING DEVELOPMENT MASTERPLAN TO COMPLETION Encounter Baptist Church, Chadstone, Vic

## Description of complex:

- This small Baptist Church with its disused tennis court and pastor's house reviewed its property in terms of its mission. The old decaying timber hall will be demolished.
- Studio B has determined that the church can be expanded with increased car parking and that 3 new houses can be built on the remainder of the site.
- A planning permit has been granted, allowing a 2-stage development including a future additional floor on the church.
- The new auditorium will seat 150 with the opportunity to expand through an operable wall.

## Design features include:

- The existing church auditorium becomes the new multi-purpose foyer.
- The existing building is on a sloping site and a lift has been incorporated to serve each level.
- Street access to the church includes an outdoor café area serviced directly from the kitchen.
- The children's spaces on the lower ground floor give direct access to an enclosed external play area.
- One of the houses will be retained by the church for the pastor. Value generated from the other two houses will be used to assist funding the church building.

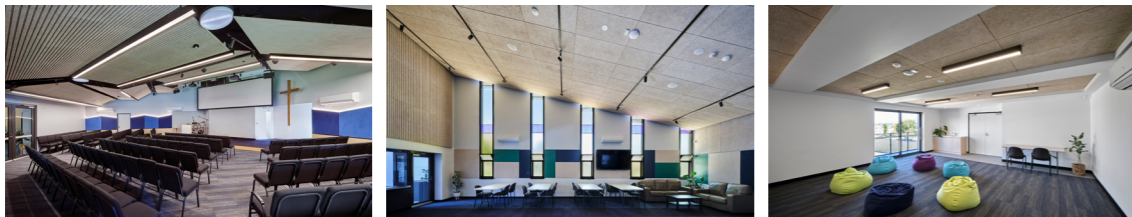

project datasheet

Studio B Architects t. 03 9486 4425 www.studiob.net.au