

NEW CHURCH COMPLEX CONCEPT TO CONTRACT DOCUMENTATION The Wave, Ocean Grove Baptist Church

Ocean Grove Baptist Fellowship commissioned this new building to provide a permanent home for this 10 year old church community.

The accommodation includes 400 seat auditorium, cafe/foyer, creche cry room, 2 multi-purpose children's church rooms and 3-way serving kitchen. Externally there is an enclosed children's play area and a landscaped barbecue area. It is intended to add sailcloth canopies and a heritage trail commemorating the christian founders of Ocean Grove.

Design features include:

- It was built on an entry route to the town, located in a residential area but establishing a landmark by its distinctive materials and wave shaped roof.
- This roof shape alludes to the church's youthful surfer membership and coastal setting and serves a clear practical internal purpose. The songs are projected onto a screen above those leading services on the platform, hence the roof shape to accommodate this focus.
- For both economy and environmental sustainability the building reuses a 20 year old redundant steel structure acquired from elsewhere. This is adapted and simply extended to create a distinctive building clad in Australian hardwood, cream render and zincalume roofing.
- The practice took the scheme to appeal at VCAT to achieve the palate of materials

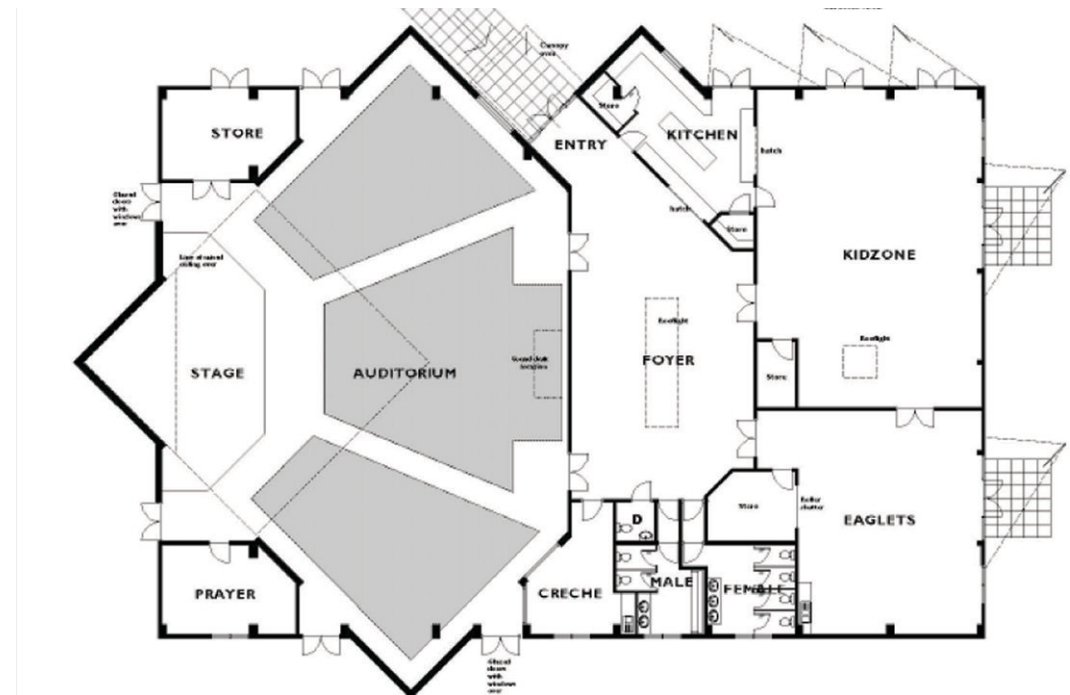

project datasheet

Studio B Architects t. 03 9486 4425 www.studiob.net.au

Fred Batterton